

Jaquith Industries Inc.

600 East Brighton Ave.
PO Box 780
Syracuse, NY
13205-0780
315-478-5700
Fax: 315-478-5707

Specifications

Vertical Curb Form

Height, in.	12 to 24
End Connection	two dowels (electro-welded)
Length, ft.	10
Division Plate Slots	one, five feet from end, for use with O-K type skeleton division plate

Permanent Partial Batter Curb Form

Height, in.	12 to 24
End Connection	two dowels (electro-welded)
Length, ft.	10
Batter	specify A&B batter dimensions (see sketch on page 12)

Batter Plate

Height, in.	6 to 9
Form Connection	two #19 slotted bolts with taper keys
Length, ft.	10
Batter	specify A&B batter dimensions (see sketch on page 12)

Super Curb Form Division Plates

Width, in.	5 to 9
Height, in.	12 to 24
BMF supplies division plates to customer specifications for any type of curb (vertical, partial batter, or full batter). A minimum of one full depth plate and one Hi-Top spacer is recommended per ten foot.	
See Guide to Ordering.	

Partial Batter Curb to Slab with Face form.

For this type of setup you can set a vertical, battered, inverted-J face form on the concrete slab. All you need are two Adjustable Hanger accessories (per 10 ft length) to connect with the curb form, and an Adjustable Diagonal Brace accessory for additional curb support.

bmf[®] Metal Forms

Super Curb Forms

BMF Super Forms are engineered for those projects where specifications require either full or partial battered design and, that the forms must be left in place until final set of the concrete. Super Forms permit the pulling of division plates immediately after the concrete is poured and vibrating specifications are met.

Super Curb Forms

Super Curb Form division plates are placed at the ends of the form and are edge-designed to permit pulling clearance for the plate, regardless of type of curb — vertical, partially battered, or fully battered. One Hi-Top spacer designed for external support of the forms is recommended and should be placed midway on the form.

Super Curb Forms are positively aligned by husky dowels in mating end connections. These connections assure squaring off of the division plates and alignment.

Three stake pockets per form are electro-welded under top rail and over bottom flange to form a box that gives maximum strength and support. Heavy 3/8" thick giant wedges permit uniform alignment independent of grade. All Super Forms have two holes in top and bottom flanges to permit stacking.

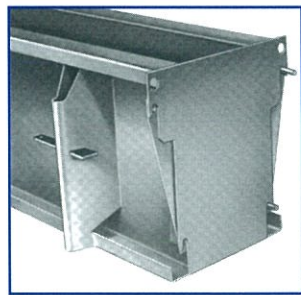

Full Batter Curb



Vertical Curb



Partial Batter Curb with Face Form

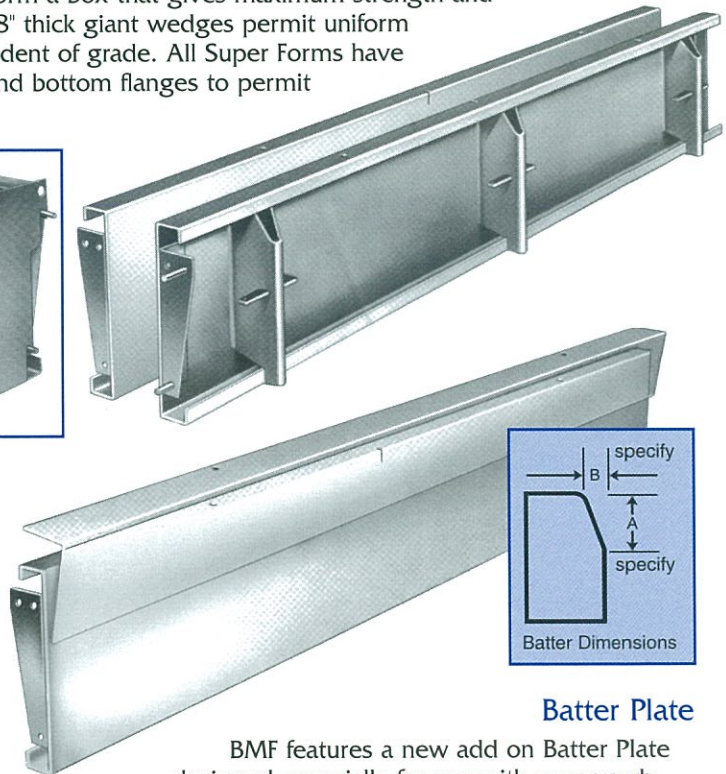
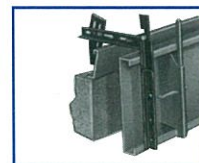

Batter Plate

BMF features a new add on Batter Plate designed especially for use with super curb forms. Specified batter is formed to 10' lengths (or shorter if required) and holes are punched to align with those in top rail of form. Slotted bolts and taper keys lock the plate to rail. When ordering, specify A&B dimensions for required length and batter.

No matter what your curb requirements may be, vertical, full battered, partially battered, with division plates, without division plates, side braced or top spaced — or both, BMF engineers a Super Curb Form and the necessary accessories to do the job.

Some, but not all types and possible combinations are illustrated here. BMF sales engineers will be pleased to help you select forms for the most efficient settings and the greatest possible utility.

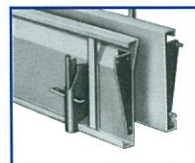

Partial Batter Curb (permanent in Form)